

Part #	Prepared By
Project	Notes
Type	
Date	

10" Round, F-Class Gen V

Lensed LED Downlight, 1000-7000 Lumens



Features & Specifications

ELECTRICAL SYSTEM

- 1100 - 7000 lumens
- 2700K - 5000K CCT
- Optional Tunable White, 2700K - 6500K or 1800K - 4000K CCT
- 80 CRI with 3 SDCM color consistency (+90 CRI optional)
- Standard 0-10V 1% dimming driver, ZDM; optional drivers available
- 120V - 277V Universal Input Volts, 347V option
- Minimum 50,000 hour lifetime at L70
- -20°C to 30°C Ambient Operating Temperature Range

OPTICS

- Precision spun architectural-grade reflector
- Reflectors available in Alzak® and painted finishes
- Distribution is free of streaks, striations and hotspots
- 80° Wide distribution
- 45° Cutoff

FRAME & MOUNTING

- Galvanized steel frame with integrated junction box featuring hinged access covers with spring retaining latches
- Vertically adjustable rigid formed mounting brackets that accept a variety of mounting bars with auxiliary nail holes and T-bar slots
- T-Bars included, suitable for joist spacing from 12" to 24"
- Supports straight conduit runs - (3) 3/4" knockouts
- Through branch wiring - (8) #12 AWG (4 in, 4 out), 90°C conductors
- Accessibility to all LED components from below ceiling
- Flush to the ceiling reflectors, secured by high quality friction clips

Listings

- ETL certified to UL 1598 and UL8750 requirements
- Tested according to LM-79 and LM-80 standards
- Energy Star® certified versions available (see Vantage Energy Star® guide for details)
- Suitable for damp locations under covered ceiling
- Buy American Act (BAA)

Warranty & Notes

- 5-year limited warranty on LED module and driver
- www.vantageltg.com/product-warranty
- Photometric tests performed by an accredited NVLP facility and in accordance to IESNA LM-79-2008 testing procedures
- Insulation must be kept 3" away from luminaire

Lumens*

Nominal Lumens	Wattage
1100	15.4
1500	21.6
2000	27.2
3000	33.2
4000	45.6
5000	58.5
6000	60.1
7000	85.3

All measured at 3500K with a standard wide distribution
**Actual Wattage/Lumens may vary.*

Ordering Information

EXAMPLE: A10VEFLEDU-1135K-W1011-SGC-ZDM

Series	Voltage	Lumens	Kelvin (CCT)	Reflector	Finishes	Options**	
A10VEFLED	U - 120V-277V 1 - 120V 2 - 277V 3 - 347V (347V Step Down Transformer) *Must provide voltage when optional drivers are selected.	11 - 1100 15 - 1500 20 - 2000 30 - 3000 40 - 4000 50 - 5000 60 - 6000 70 - 7000	27K - 2700K 30K - 3000K 35K - 3500K 40K - 4000K 50K - 5000K TWC - Tunable White Full Color (2700K-6500K)* TWW - Turnable White Warm Color (1800K-4000K)* DTW - Dim-to-Warm (1800K-3000K)** *Available up to 2000 lumens **Available up to 5000 lumens	W1011 W1011P W1011FR W1011FRP W1014 W1014P W1012D W1014D W1016D W1018D	SCL Specular Clear SGC Soft Glow Clear WHT White Matte *All trims supplied standard with white painted flange.	ZDM (standard) DTD DTDHL DMX DCA TDM DDM DDMHO DL-2 DL-3 LDE1 PEQ0 PSQ0	HCR PF EM17 EM117 EM20 EMI20 EM-CW-LED GR-10-"xx" GTD SENSDYOC BRGESEN

*Lens Notes

W1011 - Wide Beam Clear Glass Lensed Reflector
W1011P - Wide Beam Clear Polycarbonate Lensed Reflector
W1011FR - Wide Beam Frosted Glass Lensed Reflector
W1011FRP - Wide Beam Frosted Polycarbonate Lensed Reflector
W1014 - Wide Beam Prismatic Glass Lensed Reflector
W1014P - Wide Beam Prismatic Acrylic Lensed Reflector
W1012D - BeamShaper® Lens, 20° Beam Angle Reflector
W1014D - BeamShaper® Lens, 40° Beam Angle Reflector
W1016D - BeamShaper® Lens, 60° Beam Angle Reflector
W1018D - BeamShaper® Lens, 80° Beam Angle Reflector

**Options Notes

ZDM - 0-10V 1% dimming driver (standard)
DTD - 0-10V 0.1% dimming driver. (up to 4000 lumens)
DTDHL - 0-10V 0.1% dimming driver. (use with 5000 - 7000 lumens)
DMX - DMX with RDM dimming driver, requires DCA

DCA - Daisy Chain Adaptor

TDM - Triac (Forward Phase, 120V only) dimming driver. (up to 5000 lumens)
DDM - Dali Driver (up To 5000 Lumens)
DDMHO - Dali Driver (use with 6000 and 7000 Lumens)
TWC - Tunable White Full Color 27k-65k, 90+ Cri With 0-10v Dual Control And 0.1% Dimming. (up to 2000 Lumens)
TWW - Turnable White Warm Color 18k-40k, 90+ Cri With 0-10v Dual Control And 0.1% Dimming. (up to 2000 Lumens)
DTW - Dim-to-Warm 18K-30K, 90CRI with 0-10V. (up to 5000 lumens)
DL-2 - Lutron 2-Wire Hi-Lume dimming driver. (up to 3000 lumens)
DL-3 - Lutron Hi-Lume 1% 3-wire dimming driver. (up to 3000 Lumens)
LDE1 - Lutron Hi-Lume 1% with Soft-On, Fade-to-Black dimming driver. (up to 4000 lumens)
PEQ0 - Lutron Hi-Lume Premier 0.1% with Soft-On, Fade-to-Black dimming driver. (up to 4000 lumens)

PSQ0 - Lutron Eco-system Tunable White Driver .1% (up to 2000 lumens, requires TWW or TWC and ECOSYSTEM PROJECT ID)

HCR - High CRI, 90+ minimum. (Not available in 5000 Kelvin)
PF - Polished Flange
AT - Air Tight
EM17 - Battery Backup W/remote Test Button & Indicator Light (for 800-5000 Lumens)
EM117 - Battery Backup W/integral Test Button & Indicator Light (for 800-5000 Lumen)
EM20 - Battery Backup W/remote Test Button & Indicator Light (for above 5000 Lumen)
EMI20 - Battery Backup W/integral Test Button & Indicator Light (for above 5000 Lumen)
EM-CW-LED - Cold Weather Rated Emergency Driver
GR-10-"xx" - 10" Goof Ring (inner Dimension - Specify outer dimension in place of 'xx')
GTD - Generator Transfer Device
SENSDYOC - Daylight/occupancy Sensor - remote mount
BRGESEN - Bridge up to 400 Watts for Sesndyoc

Vantage reserves the right to change components, finishes or design details in any manner which does not alter the installed appearance or reduce performance and intended function.

10" Round, F-Class Gen V

Lensed LED Downlight, 1100-7000 Lumens

Dimensional Data

Ceiling Cut Out 10.13"

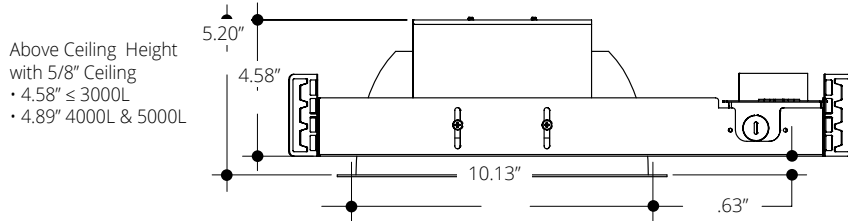

Above Ceiling Height
 • Maximum Ceiling Thickness 1.19" - 4.01"
 • Minimum Ceiling Thickness 0.12" - 5.08"

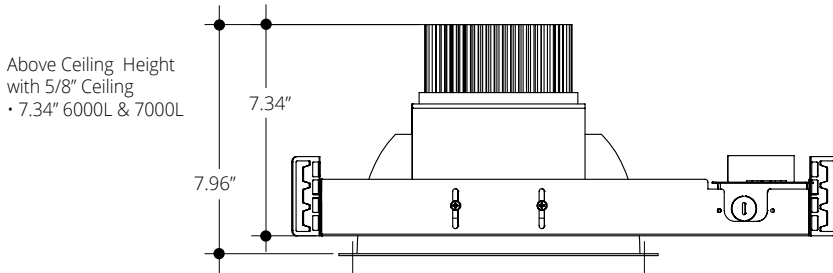
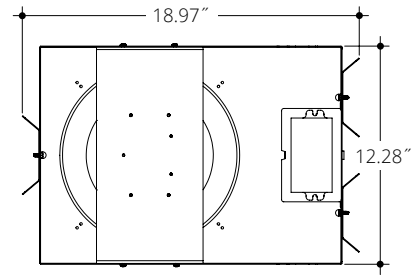

Above Ceiling Height
 • Maximum Ceiling Thickness 1.19" - 6.77"
 • Minimum Ceiling Thickness 0.12" - 7.84"

Reflector Finishes / Lens Options

