

6"X10" Architectural Cylinder

Open LED 1100-3000 Lumens

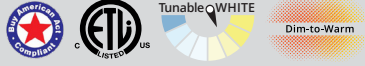

Features & Construction

ELECTRICAL SYSTEM

- 1100 - 3000 Lumens
- 2700K - 4000K CCT
- Tunable White and Dim-To-Warm options
- 80 CRI with 3 SDCM color consistency, 90+ CRI available
- Standard 0-10V 1% dimming driver (ZDM)
- 120V - 277V Universal Input Volts
- Minimum 50,000 hour lifetime at L70
- -20°C to 30°C Ambient Operating Temperature Range

OPTICS

- Precision spun architectural-grade reflector
- Reflectors available in Alzak® and painted finishes
- Distribution is free of streaks, striations and hotspots
- 80° Wide Distribution

HOUSING & MOUNTING

- .064" thick spun aluminum cylinder
- Exterior paint with standard finishes of white, black, bronze, silver or custom color
- Heatsink - Integrated aluminum heat sink for superior thermal management.
- 4 mounting solutions, Ceiling/Surface, Wall, Cord & Cable and Pendant mount
- Pendant Mount - 3/8" IP x 12" long rigid stem with a 45° swivel canopy for sloped ceiling applications.
- Cord & Cable Mount - 72" cord provided standard

Listings

- ETL certified to UL 1598 and UL8750 requirements
- Tested according to LM-79 and LM-80 standards
- Suitable for damp locations; Wet location under covered ceiling (per NEC 410 & UL 1598)
- Buy American Act (BAA)

Warranty & Notes

- 5-year limited warranty on LED module and driver
- www.vantageltg.com/product-warranty
- Photometric tests performed by an accredited NVLP facility and in accordance to IESNA LM-79-2008 testing procedures

Lumens*

Nominal Lumens	Delivered Lumens	Wattage	Lumens Per Watt
1100	858	15.4	55.71
1500	1171	21.6	54.21
2000	1561	24.74	63.10
3000	2341	33.5	69.88

All measured at 3500K with a standard wide distribution

*Actual Wattage/Lumens may vary.

Mounting Options Notes

P-"XX" - 3/8" IP x 12" rigid stem with swivel canopy to accommodate sloped ceilings up to 45°. Standard Pendant lengths (stem): 12", 24", and 36". If a different length is desired, please specify in 12" increments and add a field cut kit to the order (CH34TK).
CCK-"XX" 5 conductor cord to support 0-10V dimming (standard). Other lengths available.
Optional Drivers - Requires larger canopy, see canopy details for more information

Ordering Information

EXAMPLE: VC610PLEDU-3035K-WHT-SGC-ZDM-CKK-24

Mounting Options	Series	Voltage	Lumens	Kelvin (CCT)*	Housing Finish	Reflector Finish	Dimming* Options	Additional Options*
VC Ceiling Mount	610PLED	U - 120V-277V 1 - 120V 2 - 277V	11 - 1100 15 - 1500 20 - 2000 30 - 3000	27K - 2700K 30K - 3000K 35K - 3500K 40K - 4000K TWC - Tunable White Full Color* 2700K - 6500K TWW - Tunable White Warm Color* 1800K - 4000K DTW - Dim-To-Warm* 1800K - 3000K	WHT White Matte BLK Black Matte BZ Bronze CS Silver CC Custom Color	SCL Specular Clear SGC Soft Glow Clear WHT White Matte	ZDM (Standard) DTD TDM DL-2 DL-3 LDE1 PEQ0 PSQ0	HCR REM P-"xx" CH34TK CCK-"xx" FCJS-ECO FCJS-010 FCJS-ECO-EM FCJS-010-EM FC-SENSOR FC-VSENSOR

*Driver Options Notes

ZDM - 0-10V 1% dimming driver (standard)
DTD - 0-10V 0.1% Dim-To-Dark dimming driver.
TDM - Triac (Forward Phase, 120V only) dimming driver.
DL-2 - Lutron 2-Wire Hi-Lume dimming driver. (up to 3000 lumens)
DL-3 - Lutron Hi-Lume 1% 3-wire dimming driver. (up to 3000 Lumens)
LDE1 - Lutron Hi-Lume 1% with Soft-On, Fade-to-Black dimming driver. (up to 4000 lumens)
PEQ0 - Lutron Hi-Lume Premier 0.1% with Soft-On, Fade-to-Black dimming driver. (up to 4000 lumens)
PSQ0 - Lutron Eco-system Tunable White Driver. 1% (not available above 2000 lumens (requires TWW or TWC and ECOSYSTEM PROJECT ID)

*Tunable Color Notes

TWC - Tunable White Full Color 27K-65K, 90+ Cri With 0-10v Dual Control and 0.1% Dimming. (up to 2000 Lumens) (Only available in VP Mount)
TWW - Turnable White Warm Color 18K-40K, 90+ Cri With 0-10v Dual Control And 0.1% Dimming. (up to 2000 Lumens) (Only available in VP Mount)
DTW - Dim-to-Warm 18K-30K, 90CRI with 0-10V and 0.1% Dimming. (up to 5000 Lumens)

*Additional Options Notes

HCR - High CRI, 90+ minimum
REM - Remote Battery Backup W/remote Test Button And Indicator Light (up to 5000 Lumens)
P-"XX" - Specify length of Pendant Mount
CH34TK - Field Cut Kit For Stems
CCK-"XX" - Specify length of Cord & Cable Kit
FCJS-ECO - Vive PowPak EcoSystem Control Module
FCJS-010 - Vive PowPak 0-10 V Control Module, 1 A Switched
FCJS-ECO-EM - Emergency rated Vive PowPak EcoSystem Control Module
FCJS-010-EM - Emergency rated Vive PowPak 0-10 V Control Module, 1 A Switched
FC-SENSOR - Combo Occupancy & Daylight Sensor, Wired (used only with FCJS-ECO and FCJS-010 modules)
FC-VSENSOR - Combo Vacancy & Daylight Sensor, Wired (used only with FCJS-ECO and FCJS-010 modules)

6"X10" Architectural Cylinder

Open LED 1100-3000 Lumens

Dimensional Data

VC - CEILING/SURFACE MOUNT

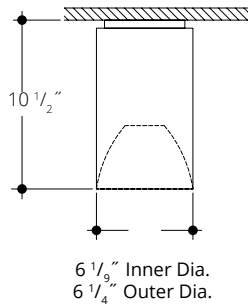

VW - WALL MOUNT

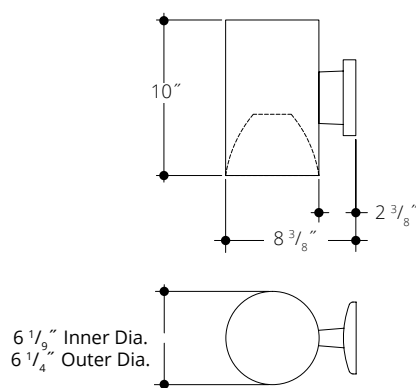

VP - PENDANT MOUNT

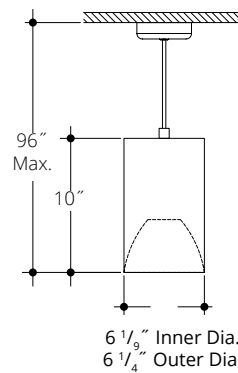

VC WITH CCK-"XX" - CORD & CABLE MOUNT

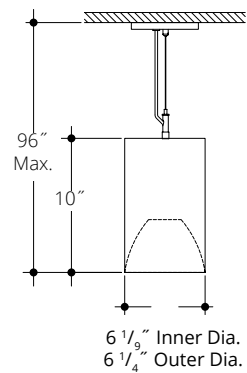

HOUSING FINISHES



WHT
WHITE MATTE

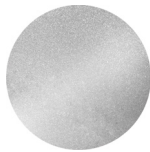

CS
SILVER



BLK
BLACK MATTE



BZ
BRONZE

REFLECTOR FINISHES



SCL
SPECULAR CLEAR



SGC
SOFT GLOW CLEAR



WHT
WHITE MATTE

PHOTOMETRY

WD - Wide 80°

Model

VC614PLED-WE-2035K,
VP614PLED-WE-2035K,
VW614PLED-WE-2035K,

Lumens

1,561

Watts

24.74

Efficacy

63.10

SC

1.61

Candela Curve

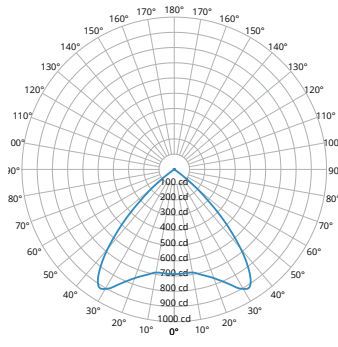

Cone of Light

Mounting Height AFF	FC at Center on Floor	Beam Diameter
8.0'	11 fc	15.6'
10.0'	7 fc	19.5'
12.0'	5 fc	23.4'
14.0'	4 fc	27.3'
16.0'	3 fc	31.3'
20.0'	2 fc	39.1'
24.0'	1 fc	46.9'
30.0'	1 fc	58.6'

Candela Table

	0.00°
	688
0.00°	688
5.00°	686
15.00°	718
90.00°	0

Zonal Lumen Summary

Zone	Lumens	% Luminaire
0° - 30°	659	42%
0° - 40°	1,189	76%
0° - 60°	1,557	100%
60° - 90°	19	1%
0° - 20°	272	17%
20° - 50°	1,261	81%
50° - 70°	136	9%
70° - 90°	1	0%
0° - 90°	1,561	100%
90° - 180°	0	0%
Total	1,561	100%

Spacing Criterion

Height	Spacing	Light Level*
8 ft	12.9 ft	~ 11 fc
10 ft	16.1 ft	~ 7 fc
12 ft	19.3 ft	~ 5 fc
8 ft	9.7 ft	~ 19 fc
10 ft	12.1 ft	~ 12 fc
12 ft	14.5 ft	~ 8 fc
8 ft	6.4 ft	~ 43 fc
10 ft	8.1 ft	~ 28 fc
12 ft	9.7 ft	~ 19 fc

* approximate direct light level at floor based on spacing criterion overlap

MULTIPLIER

CRI	Multiplier	Kelvin	Multiplier	Reflector Finish	Multiplier
80	1	2700K	0.939	SCL	1
90	0.8	3000K	0.975	SGC	0.95
		3500K	1	WHT	0.87
		4000K	1.035		

6"X10" Architectural Cylinder

Open LED 1100-3000 Lumens

Canopy Information

VP - With Standard Driver

Pendant Mount, rigid stem, swivel canopy, up to 45° slope ceiling

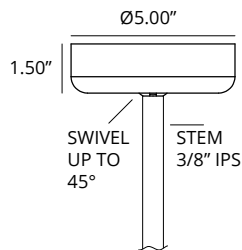

Driver Compatibility

ZDM - 0-10V 1% Dimming
Standard

VP - With Optional Drivers

Canopy for larger driver options. Driver located in canopy.

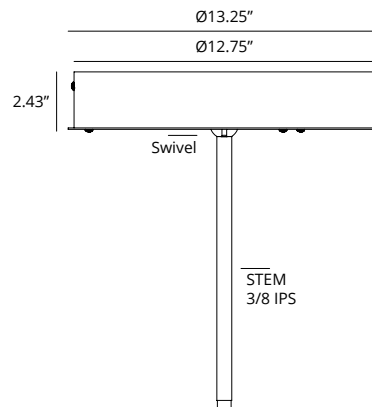

Driver Compatibility

TDM
TWC - Tunable White Full Color, 0.1% 0-10V
TWW - Tunable White Warm Color, 0.1% 0-10V
DTW - Dim-to-Warm, 0.1% 0-10V
DTD
DL-2
DL-3
LDE1
PEQ0
PSQ0

CCK - With Standard Driver

Cord & Cable Mount, fixed canopy (standard)

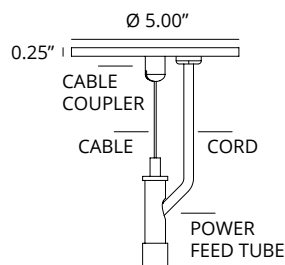

Driver Compatibility

ZDM - 0-10V 1% Dimming
Standard

CCK - With Optional Drivers

Cord & Cable Mount, fixed canopy (standard)

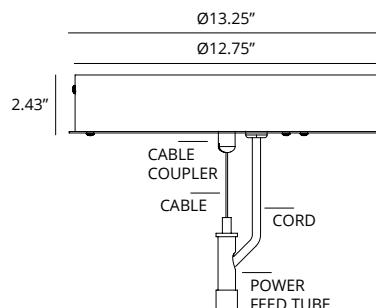

Driver Compatibility

TDM
TWC - Tunable White Full Color, 0.1% 0-10V
TWW - Tunable White Warm Color, 0.1% 0-10V
DTW - Dim-to-Warm, 0.1% 0-10V
DTD
DL-2
DL-3
LDE1
PEQ0
PSQ0

WALL MOUNT EXTENSION

Wall Mount Extension for larger optional drivers

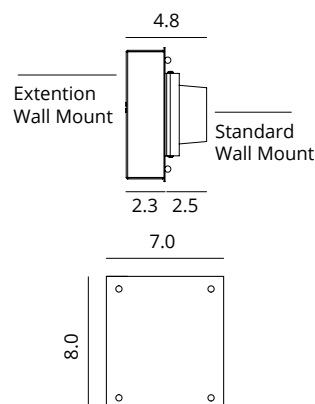

Driver Compatibility

TDM
TWC - Tunable White Full Color, 0.1% 0-10V
TWW - Tunable White Warm Color, 0.1% 0-10V
DTW - Dim-to-Warm, 0.1% 0-10V
DTD
DL-2
DL-3
LDE1
PEQ0
PSQ0