

Project Name: _____ Type: _____

DIMENSIONS

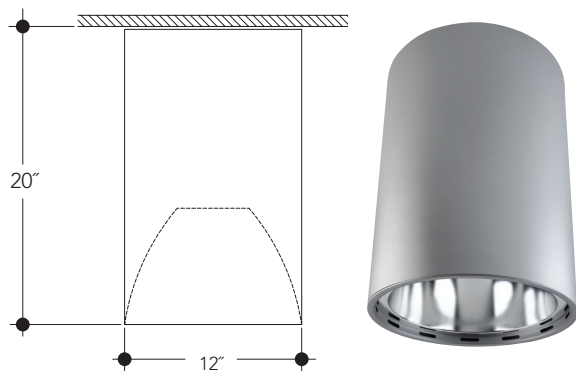

FEATURES

High Performance LED Array

A high output module featuring a wide variety of lumen and color packages. Standard solid state driver, provides stable and efficient performance and a variety of dimming control options.

Benefits

- Highly energy efficient solution: up to 130 lumens per watt.
- Wide range of color temperatures 2700 - 4000K.
- Module features high quality accurate color production and uniform consistent white light.
- Color consistency within a 3 step MacAdam ellipse.
- Minimum 80 CRI standard. Optional 90 CRI available.
- 0-10V Dimmable driver to 10% light output standard.
- Optional dimming drivers include 0-10V to 1%, DMX and DALI.

Cylinder

Housing is .064" thick spun aluminum cylinder. Polyester powdercoat exterior finish with factory standard colors White (WHT), Black (BLK), Bronze (BZ), Silver (CS).

VC Mounting - Ceiling mount over recessed octagonal or 4" square junction box (by others).

VP Mounting - Pendant mount with 3/8" IP x 12" long rigid stem and swivel canopy for mounting on sloped ceilings up to 45°. Custom length stems available.

VW Mounting - Wall mount bracket constructed of cast aluminum and designed for mounting over recessed junction box. (by others).

CCK Cord and Cable Mounting kits available, standard length 72", other lengths available. Provided with 5 conductor cord to support 0-10V dimming.

CYLINDER STYLES

OPEN

Ceiling Mount

10" Aperture

VC1220BLED Ceiling Mount 12"x20"
Vertical LED

Distribution Options

MD Medium
WE Wide

Finish Options

SCL Specular Clear "Alzak"
SGC Soft Glow Clear
WHT White Reflector

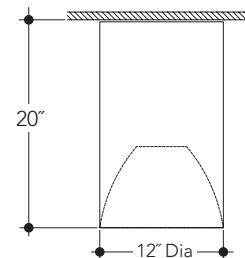

Pendant Mount

10" Aperture

VP1220BLED Pendant Mount 12"x20"
Vertical LED

Distribution Options

MD Medium
WE Wide

Finish Options

SCL Specular Clear "Alzak"
SGC Soft Glow Clear
WHT White Reflector

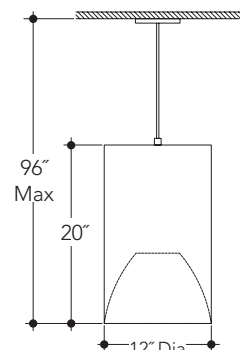

Wall Mount

10" Aperture

VW1220BLED Wall Mount 12"x20"
Vertical LED

Distribution Options

MD Medium
WE Wide

Finish Options

SCL Specular Clear "Alzak"
SGC Soft Glow Clear
WHT White Reflector

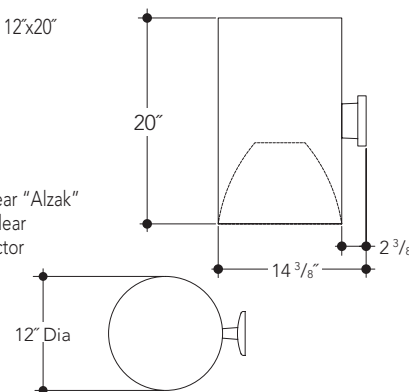

Manufactured and Listed to UL 1598, ETL and CSA standards.
Interior use only.

ORDERING INFORMATION

EXAMPLE: VC1220BLED-4030K-WHT-SGC-DMX

Wattage LED	Mounting	Series	Lumens	Kelvin	Distribution	Color	Finish	Options
See Chart	VC	1220BLED	-40 = 4000	27K = 2700K	MD	WHT	SCL	CCK-(XX")
Below	VP		-50 = 5000	30K = 3000K	WE	BLK	SGC	DDM
	VW		-60 = 6000	35K = 3500K		BZ	WHT	DMX
			-80 = 8000	40K = 4000K		CC		HCR
			-100 = 10000			CS		P-(XX")
			-120 = 12000					REM
			-150 = 15000					ZDM

Lumens	Wattage*
4000	43W
5000	58W
6000	71W
8000	86W
10000	106W
12000	126W
15000	159W

*Actual Wattage/Lumens may vary.

Options

CCK-(XX") - Cord and Cable Mounting Kit
DDM - Dali Dimming
DMX - DMX dimming to < 1% with RDM
Up to 10,000 lumens only

HCR - High Color Rendering - 90 CRI Min.
P-(XX") - Additional Stem Length
(Specify Length)
REM - Remote Emergency Battery Backup
REM not available with the CCK
(cord & cable kits)
ZDM - 0-10V Dimming to 1%

▲ See Options pages for other options and finishes.