

Architectural Cylinders

Job Name _____

Type _____

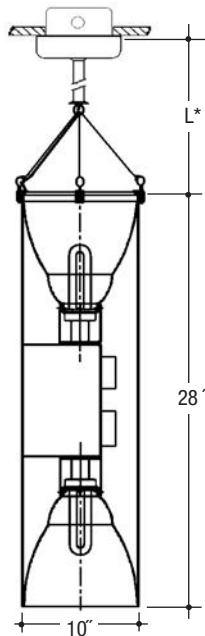

**10"x28" V.F.
OPEN OR BAFFLED
UP/DOWN**

VP1028VFU1/D1 – Pendant Mount

Cylinder – Pendant Mount Vertical Fluorescent 1-Lamp Up 1-Lamp Down (Triple or Quad Tube) "Alzak" Reflector or Baffle
Catalog Number _____ / _____

VP1028VFU1/D1	Up Wattage	Down Wattage	Ballast	Voltage	Finish	Reflector	Options
	42W MAX. TRT 32W TRT 26W DTT, TRT 18W DTT, TRT 13W DTT	42W MAX. TRT 32W TRT 26W DTT, TRT 18W DTT, TRT 13W DTT	E DA	1 2	BLK WHT BZ CS	SCL SGC WHT SCL/BL SCL/WH	REM

Electronic Multi-Tap Ballast 120 Thru 277V Factory Standard

Specifications

Housing – .064" thick spun aluminum cylinder. Polyester powdercoat exterior finish with factory standard finishes White (WHT), Black (BLK), Bronze (BZ), Camero Silver (CS).

Socket – Thermo-plastic and positive locking. *UL Listed*.

Ballast – Electronic ballasts, Class P, 50/60 HZ-120/277, Programmed Start, thermally protected, 98% Power Factor, 1.00 Ballast Factor, <10% THD, Class A sound rated. Minimum starting temperature -18°C/0°F. *UL Listed* component.

Reflector – Heavy gauge hand spun aluminum reflector with a specular "Alzak" low iridescent finish or multi-groove baffle.

Pendant – Pendant mount accepts slope ceilings with a 45° swivel adjustment. Aircraft cable and couplings for support. L* – Specify. Consult Factory.

Voltage

- 1 120 Volt
- 2 277 Volt

Ballast

- E Electronic (4 Pin Lamp)
- DA Advance Mark X Dimming (4 Pin Lamp)
- * 13 Watt Advance Mark VII Only (4 Pin Lamp)

Reflector Options ▲

- SCL Specular Clear "Alzak"
- SGC Soft Glow Clear "Alzak"
- WHT White Reflector
- SCL/BL Specular Clear "Alzak" with Black Baffle
- SCL/WH Specular Clear "Alzak" with White Baffle

Options ▲

- REM Remote Emergency Battery

Features

Manufactured and Listed to UL 1598, ETL and CSA standards. Suitable for Damp Locations Wet location under covered ceiling



▲ See Options and Finishes pages for a list of additional finishes and equipment.

Vantage reserves the right to change components, finishes or design details in any manner which does not alter the installed appearance or reduce performance and intended function.



Photometric Information

Product Number: VP1028VFU32/D32E1/2-SCL
Frame In Kit: 10"x28" Pendant Mount Vertical Fluorescent
Reflector: 8" Vertical Clear "Alzak" Reflector
LTL Test Number: 06241
Lamp(s) Source: (1) 32W PLT 4 pin lamp rated at 2400 lumens
Total Luminaire Efficiency: 59.5%
CIE Type: Direct
Luminaire Spacing Criterion: 1.3/1.3
Luminous Diameter: 7.500

Product Number: VP1028VFU42/D42E1/2-SCL
Frame In Kit: 10"x28" Pendant Mount Vertical Fluorescent
Reflector: 8" Vertical Clear "Alzak" Reflector
LTL Test Number: 06283
Lamp(s) Source: (1) 42W PLT 4 pin lamp rated at 3200 lumens
Total Luminaire Efficiency: 43.4%
CIE Type: Direct
Luminaire Spacing Criterion: 1.0/1.0
Luminous Diameter: 7.500

Zonal Lumen Summary

ZONE	LUMENS	%LAMP	%FIXTURE
0- 30	734	30.6	51.4
0- 40	1136	47.3	79.6
0- 60	1427	59.5	100.0
0- 90	1427	59.5	100.0
90-180	0	0.0	0.0
0-180	1427	59.5	100.0

Cone of Light

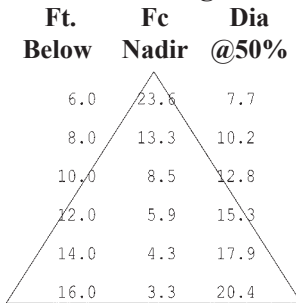

Zonal Lumen Summary

ZONE	LUMENS	%LAMP	%FIXTURE
0- 30	932	29.1	67.1
0- 40	1261	39.4	90.8
0- 60	1389	43.4	100.0
0- 90	1389	43.4	100.0
90-180	0	0.0	0.0
0-180	1389	43.4	100.0

Cone of Light

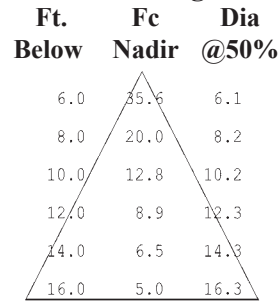

Coefficients of Utilization

RC	80			70			50			30			10			0		
RW	70	50	30	10	70	50	30	10	50	30	10	50	30	10	50	30	10	0
0	71	71	71	71	69	69	69	69	66	66	66	63	63	63	61	61	61	59
1	67	66	64	63	66	64	63	62	62	61	60	60	59	58	58	57	56	55
2	64	61	58	56	62	60	57	55	58	56	54	56	54	53	54	53	52	51
3	60	56	53	50	59	55	52	50	54	51	49	52	50	48	51	49	48	47
4	57	52	48	45	55	51	48	45	50	47	45	48	46	44	47	45	44	43
5	53	48	44	41	52	47	43	41	46	43	40	45	42	40	44	42	40	39
6	50	44	40	37	49	44	40	37	43	39	37	42	39	37	41	38	36	36
7	47	41	37	34	46	40	36	34	39	36	34	39	36	33	38	35	33	32
8	44	37	33	30	43	37	33	30	36	33	30	35	32	30	35	32	30	29
9	40	34	30	27	40	34	30	27	33	29	27	32	29	27	32	29	27	26
10	38	31	27	24	37	31	27	24	30	27	24	30	26	24	29	26	24	23

Coefficients of Utilization

RC	80			70			50			30			10			0		
RW	70	50	30	10	70	50	30	10	50	30	10	50	30	10	50	30	10	0
0	52	52	52	52	50	50	50	50	48	48	48	46	46	46	44	44	44	43
1	49	48	47	46	48	47	46	46	46	45	44	44	43	43	43	42	42	41
2	47	45	43	42	46	44	43	42	43	42	41	42	41	40	40	40	39	38
3	45	42	40	38	44	42	40	38	40	39	38	39	38	37	38	37	36	36
4	43	39	37	35	42	39	37	35	38	36	35	37	36	34	36	35	34	33
5	40	37	34	32	40	36	34	32	36	34	32	35	33	32	34	33	31	31
6	38	35	32	30	38	34	32	30	34	32	30	33	31	30	32	31	30	29
7	36	32	30	28	36	32	30	28	32	29	28	31	29	28	31	29	28	27
8	34	30	28	26	34	30	27	26	29	27	26	29	27	26	29	27	25	25
9	32	28	25	24	32	28	25	24	27	25	23	27	25	23	27	25	23	23
10	30	26	23	22	30	26	23	22	25	23	22	25	23	22	25	23	21	21



VANTAGE

