

Architectural Grade

Job Name _____

Type _____

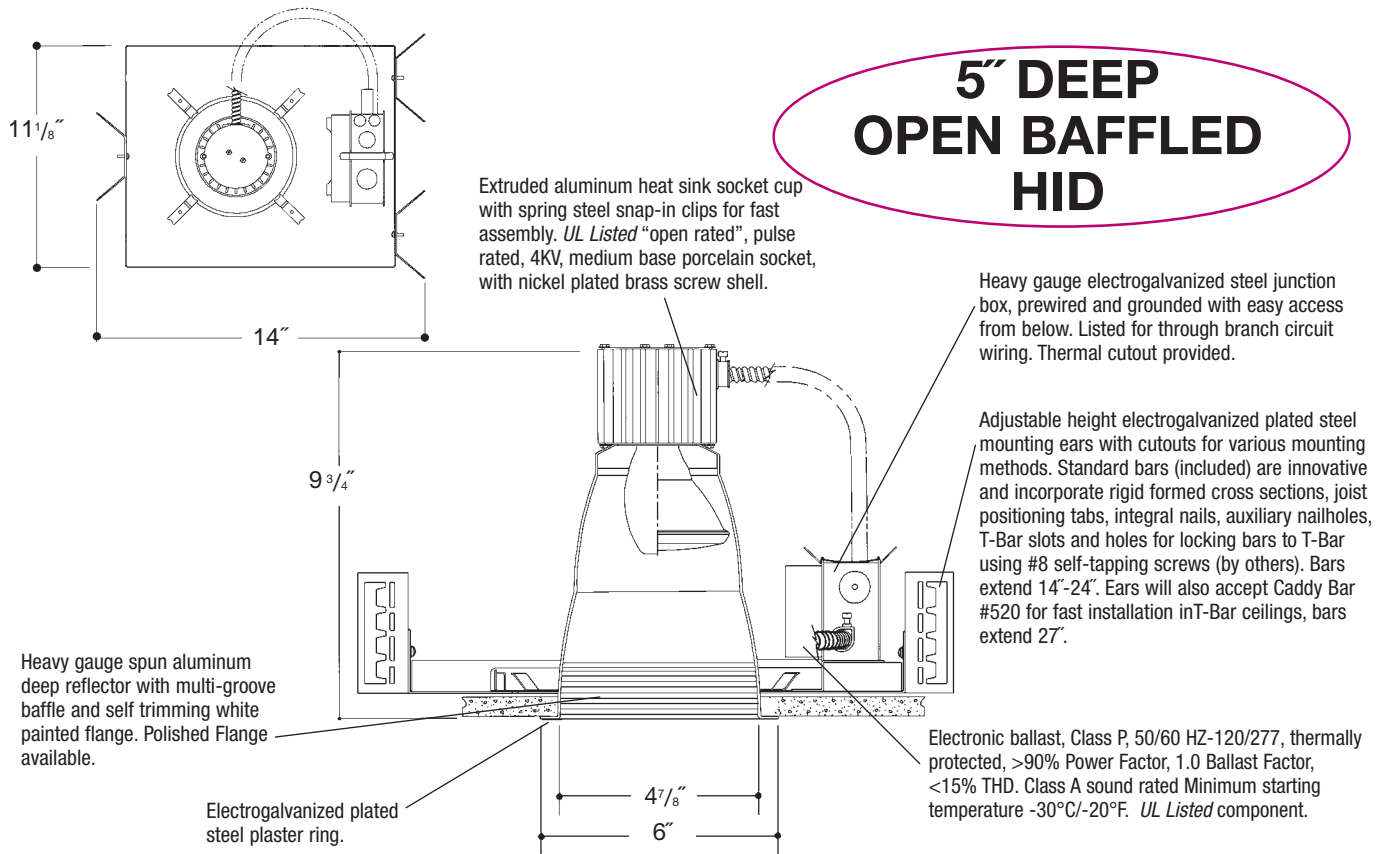

Rough In Kit – 5" HID (ED17; PAR20; PAR30 Open Rated* Lamps) *Note: 'Open Fixture Rated' lamp must be used.

Catalog Number **A5MH0**

| A5MH0 | Wattage | Ballast | Voltage | Options | Ballast E Voltage | Electronic |
|-------|----------------------|---------|---------|---------|-------------------|------------|
| | 70W MAX. PAR30, ED17 | E | 1 | | 1 | 120 Volts |
| | 50W ED17 | | 2 | | 2 | 277 Volts |
| | 35/39W PAR20, PAR30 | | 4 | | 4 | 208 Volts |
| | | | | | Options ▲ | |

PAR Lamp – Add P – PA5MH0

Finishing Kit – 5" HID Deep Open Baffled Reflector

Catalog Number **5550**

5550

Finish

Options

SCL/BL
SGO/BL
SCL/WH
SGO/WH
WHT/WH
WHT/BL

PF

Finish (Factory Standard)

SCL/BL Specular Clear "Alzak" with White Flange and Black Baffle
SGO/BL Specular Gold "Alzak" with White Flange and Black Baffle
SCL/WH Specular Clear "Alzak" with White Flange and White Baffle
SGO/WH Specular Gold "Alzak" with White Flange and White Baffle
WHT/WH White Reflector with White Flange and White Baffle
WHT/BL White Reflector with White Flange and Black Baffle

Options ▲

PF High Polished Flange

Features

Manufactured and Listed to UL 1598, ETL and CSA standards.
 Suitable for Damp Locations
 Wet location under covered ceiling



▲ See Options and Finishes pages for a list of additional finishes and equipment.

Vantage reserves the right to change components, finishes or design details in any manner which does not alter the installed appearance or reduce performance and intended function.

Vantage

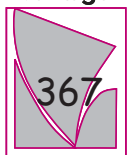

Luminaires

76 Community Avenue Plainfield, CT 06374
 voice (860) 564.4512 fax (860) 564.4854
 www.vantageitg.com

6/07