



LUMINAIRE TESTING LABORATORY, INC.



SUSTAINING
MEMBER

905 Harrison Street · Allentown, PA 18103 · (610) 770-1044 · Fax (610) 770-8912 · www.LuminaireTesting.com

LTL NUMBER: 05654

DATE: 04-20-2001

PREPARED FOR: VANTAGE LUMINAIRES

CATALOG NUMBER: 6VF142E-06000SCL

LUMINAIRE: FORMED STEEL HOUSING, SPUN SPECULAR ALUMINUM REFLECTOR, NO ENCLOSURE.

LAMP: ONE SYLVANIA CF42DT/E/IN/841 RATED AT 3200 LUMENS.

BALLAST: ONE MAGNETEK C2642UNVBES

MOUNTING: RECESSED

TOTAL INPUT WATTS = 39.4 AT 120.0 VOLTS

#05654

DEG	CANDELA	LUMENS
0	1069	
5	1137	107
15	935	265
25	832	385
35	655	410
45	430	332
55	229	199
65	26	31
75	0	0
85	0	0
90	0	

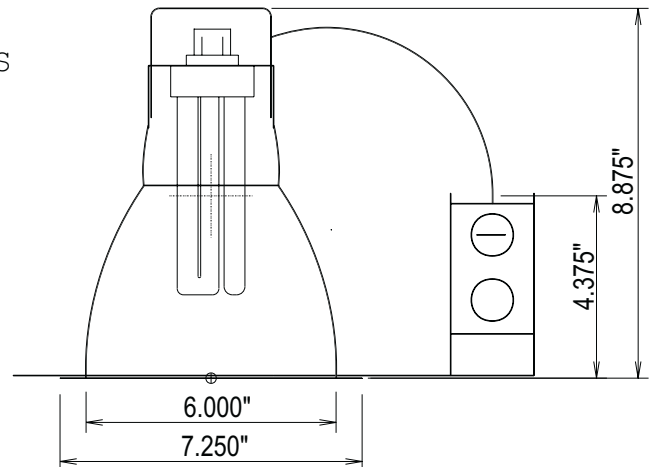

ZONAL LUMEN SUMMARY

ZONE	LUMENS	%LAMP	%FIXT
0- 30	757	23.7	43.8
0- 40	1167	36.5	67.5
0- 60	1699	53.1	98.2
0- 90	1729	54.0	100.0
90-180	0	0.0	0.0
0-180	1729	54.0	100.0

TOTAL LUMINAIRE EFFICIENCY: 54.0%

CIE TYPE: DIRECT

LUMINAIRE SPACING CRITERION = 1.1

LUMINOUS DIAMETER: 6.000

LUMINANCE IN CANDELA PER SQUARE METER

ANGLE AVERAGE

IN DEG	
0	58598.
45	33334.
55	21885.
65	3372.
75	0.
85	0.

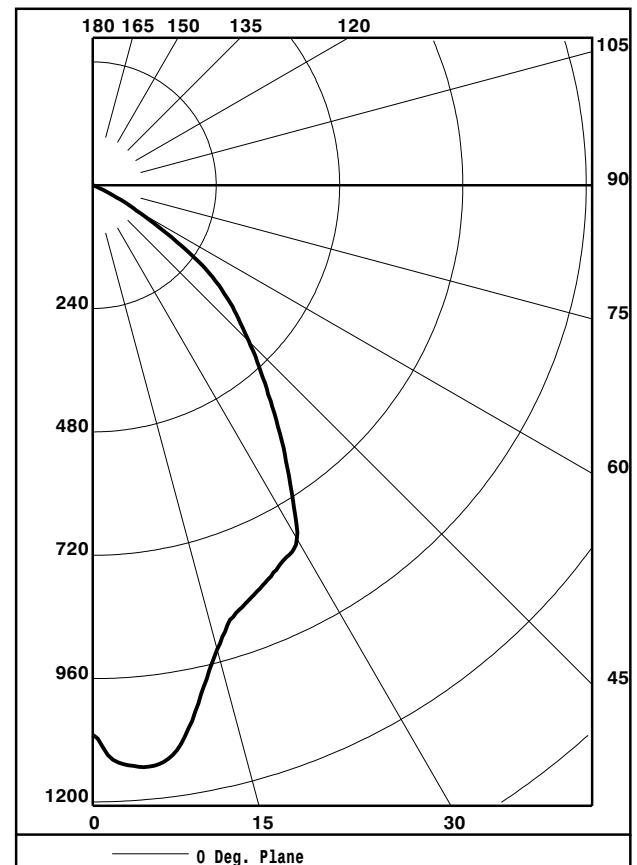

TESTED BY HERSCHEL SCHRECK
CHECKED BY MIKE GRATHER

THIS REPORT BASED ON LM-41 AND OTHER PERTINENT IES PROCEDURES.



LUMINAIRE TESTING LABORATORY, INC.



SUSTAINING
MEMBER

905 Harrison Street · Allentown, PA 18103 · (610) 770-1044 · Fax (610) 770-8912 · www.LuminaireTesting.com

LTL NUMBER: 05654

DATE: 04-20-2001

PREPARED FOR: VANTAGE LUMINAIRES

COEFFICIENTS OF UTILIZATION - ZONAL CAVITY METHOD
EFFECTIVE FLOOR CAVITY REFLECTANCE 0.20

RC	80				70				50			30			10			0
RW	70	50	30	10	70	50	30	10	50	30	10	50	30	10	50	30	10	0
0	64	64	64	64	63	63	63	63	60	60	60	57	57	57	55	55	55	54
1	61	59	58	56	59	58	57	55	56	55	54	54	53	52	52	51	50	49
2	57	54	52	50	56	53	51	49	51	50	48	50	48	47	48	47	46	45
3	54	50	46	44	53	49	46	44	47	45	43	46	44	42	45	43	42	41
4	50	45	42	39	49	45	41	39	43	41	38	42	40	38	41	39	37	37
5	47	41	38	35	46	41	37	35	40	37	34	39	36	34	38	35	34	33
6	44	38	34	31	43	37	34	31	36	33	31	36	33	31	35	32	30	29
7	41	34	31	28	40	34	30	28	33	30	28	33	30	27	32	29	27	26
8	38	31	27	25	37	31	27	25	30	27	24	30	27	24	29	26	24	23
9	35	28	24	22	34	28	24	22	27	24	22	27	24	22	26	24	21	21
10	32	26	22	20	32	26	22	19	25	22	19	25	22	19	24	21	19	18

CANDELA DISTRIBUTION

	0.0
0	1069
5	1137
10	1073
15	935
20	867
25	832
30	794
35	655
40	531
45	430
50	341
55	229
60	97
65	26
70	0
75	0
80	0
85	0
90	0

ZONAL LUMEN SUMMARY

0- 5	27.
5- 10	81.
10- 15	118.
15- 20	146.
20- 25	178.
25- 30	207.
30- 35	213.
35- 40	197.
40- 45	177.
45- 50	155.
50- 55	128.
55- 60	71.
60- 65	29.
65- 70	2.
70- 75	0.
75- 80	0.
80- 85	0.
85- 90	0.

THIS TEST WAS CONDUCTED USING RELATIVE PHOTOMETRY TECHNIQUES ACCORDING TO STANDARD IESNA PROCEDURES. THE USER MUST THEREFORE USE CAUTION IN THE FOLLOWING SITUATIONS: 1) THIS TEST WAS PERFORMED USING A SPECIFIC BALLAST/LAMP COMBINATION. EXTRAPOLATION OF THESE DATA FOR OTHER BALLAST/LAMP COMBINATIONS MAY PRODUCE ERRONEOUS RESULTS. 2) ACCORDING TO IESNA PROCEDURES, THE BALLAST(S) AND LAMP(S) ARE PRESUMED TO PRODUCE 100% OF RATED OUTPUT. AN APPROPRIATE BALLAST FACTOR MUST BE APPLIED TO THE LUMEN OUTPUT RATINGS AND LUMINOUS INTENSITY VALUES GIVEN. 3) THIS TEST WAS CONDUCTED IN A CONTROLLED LABORATORY ENVIRONMENT WHERE THE AMBIENT TEMPERATURE WAS HELD AT 25°C ±1°C. FIELD PERFORMANCE MAY DIFFER PARTICULARLY IN REGARDS TO CHANGE IN LUMINOUS OUTPUT AS A RESULT OF DIFFERENCE IN AMBIENT TEMPERATURE AND METHOD OF MOUNTING THE LUMINAIRE.



LUMINAIRE TESTING LABORATORY, INC.



SUSTAINING
MEMBER

905 Harrison Street · Allentown, PA 18103 · (610) 770-1044 · Fax (610) 770-8912 · www.LuminaireTesting.com

LTL NUMBER: 05654

DATE: 04-20-2001

PREPARED FOR: VANTAGE LUMINAIRES

VISUAL COMFORT PROBABILITY TABLE

RATED LUMENS PER LAMP 3200.

100. FC. REFLECTANCES 80/50/20
ROOM LUMINAIRES 0 DEG PLANE

LUMINAIRES 90 DEG PLANE

W	L	8.5	10.0	13.0	16.0	8.5	10.0	13.0	16.0
20	20	46	37	25	24	46	37	25	24
20	30	46	33	33	24	46	33	33	24
20	40	46	33	33	30	46	33	33	30
20	60	46	33	33	30	46	33	33	30
30	20	46	40	30	25	46	40	30	25
30	30	46	40	35	25	46	40	35	25
30	40	46	40	35	29	46	40	35	29
30	60	46	37	35	29	46	37	35	29
30	80	46	37	35	29	46	37	35	29
40	20	46	40	30	28	46	40	30	28
40	30	46	40	35	29	46	40	35	29
40	40	46	37	35	32	46	37	35	32
40	60	46	37	35	32	46	37	35	32
40	80	46	37	35	32	46	37	35	32
40	100	46	37	36	32	46	37	36	32
60	30	46	37	35	32	46	37	35	32
60	40	46	37	35	34	46	37	35	34
60	60	46	37	35	35	46	37	35	35
60	80	46	37	35	35	46	37	35	35
60	100	46	37	36	35	46	37	36	35
100	40	46	37	35	35	46	37	35	35
100	60	46	37	35	35	46	37	35	35
100	80	46	37	36	35	46	37	36	35
100	100	46	37	36	35	46	37	36	35



LUMINAIRE TESTING LABORATORY, INC.



SUSTAINING
MEMBER

905 Harrison Street · Allentown, PA 18103 · (610) 770-1044 · Fax (610) 770-8912 · www.LuminaireTesting.com

LTL TEST #05654

CIRCLE-OF-LIGHT

Ft below	FC nadir	Dia @ 50%
6.0	29.7	6.7
8.0	16.7	8.9
10.0	10.7	11.1
12.0	7.4	13.4
14.0	5.5	15.6
16.0	4.2	17.8

NOTE: 'Dia' spans the edge-points that are half of nadir FC