



LUMINAIRE TESTING LABORATORY, INC.



SUSTAINING
MEMBER

905 Harrison Street · Allentown, PA 18103 · (610) 770-1044 · Fax (610) 770-8912 · www.LuminaireTesting.com

LTL NUMBER: 06202

DATE: 10-26-2001

PREPARED FOR: VANTAGE LUMINAIRES

CATALOG NUMBER: 6HF2X13E1-6602SCL

LUMINAIRE: FORMED STEEL HOUSING, SPUN SEMI-SPECULAR ALUMINUM
REFLECTOR, NO ENCLOSURE.

LAMPS: TWO PHILIPS PL-C 13W/27/4P RATED AT 900 LUMENS EACH.

BALLAST: ONE ADVANCE ICF-2S13-H1-LD

MOUNTING: RECESSED

TOTAL INPUT WATTS = 27.8 AT 120.0 VOLTS

THE 0 DEGREE PLANE IS PARALLEL WITH THE LAMPS.

CANDELA DISTRIBUTION

	0.0	22.5	45.0	67.5	90.0	112.5	135.0	157.5	180.0	FLUX
0	430	430	430	430	430	430	430	430	430	
5	403	414	432	451	459	462	455	445	439	43
15	341	416	484	537	581	590	566	511	437	145
25	346	391	498	534	573	595	607	514	454	236
35	284	343	410	462	488	503	494	451	401	274
45	215	245	294	327	338	340	326	284	256	230
55	179	171	158	149	135	132	128	120	122	108
65	0	0	0	0	0	0	0	0	0	1
75	0	0	0	0	0	0	0	0	0	0
85	0	0	0	0	0	0	0	0	0	0
90	0	0	0	0	0	0	0	0	0	0

ZONAL LUMEN SUMMARY

ZONE	LUMENS	%LAMP	%FIXT
0- 30	424	23.5	40.9
0- 40	698	38.8	67.3
0- 60	1036	57.6	99.9
0- 90	1037	57.6	100.0
90-180	0	0.0	0.0
0-180	1037	57.6	100.0

TOTAL LUMINAIRE EFFICIENCY: 57.6%

CIE TYPE: DIRECT

PLANE: 0-DEG 90-DEG 180-DEG

SPACING CRITERIA: 1.1 1.6 1.4

LUMINOUS DIAMETER: 6.250

LUMINANCE IN CANDELA PER SQUARE METER

ANGLE IN DEG	AVERAGE 0-DEG	AVERAGE 45-DEG	AVERAGE 90-DEG
0	21723.	21723.	21723.
45	15360.	21004.	24148.
55	15766.	13916.	11890.
65	0.	0.	0.
75	0.	0.	0.
85	0.	0.	0.

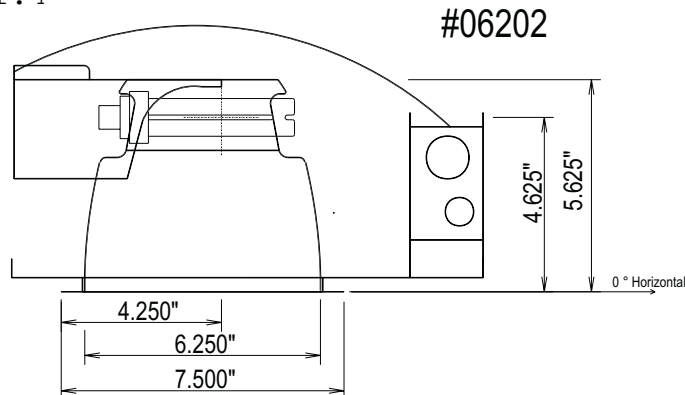

TESTED BY HERSCHEL SCHRECK
CHECKED BY MIKE GRATHER

THIS REPORT BASED ON LM-41 AND OTHER PERTINENT IES PROCEDURES.



LUMINAIRE TESTING LABORATORY, INC.



SUSTAINING
MEMBER

905 Harrison Street · Allentown, PA 18103 · (610) 770-1044 · Fax (610) 770-8912 · www.LuminaireTesting.com

LTL NUMBER: 06202

DATE: 10-26-2001

PREPARED FOR: VANTAGE LUMINAIRES

COEFFICIENTS OF UTILIZATION - ZONAL CAVITY METHOD

EFFECTIVE FLOOR CAVITY REFLECTANCE 0.20

RC	80				70				50			30			10			0
RW	70	50	30	10	70	50	30	10	50	30	10	50	30	10	50	30	10	0
0	69	69	69	69	67	67	67	67	64	64	64	61	61	61	59	59	59	58
1	65	63	61	60	63	62	60	59	59	58	57	57	56	55	55	54	54	53
2	61	58	55	53	60	57	54	52	55	53	51	53	51	50	52	50	49	48
3	57	53	50	47	56	52	49	46	50	48	46	49	47	45	48	46	44	43
4	53	48	44	42	52	48	44	41	46	43	41	45	42	40	44	42	40	39
5	50	44	40	37	49	43	40	37	42	39	36	41	38	36	40	38	36	35
6	46	40	36	33	45	40	36	33	39	35	33	38	35	32	37	34	32	31
7	43	36	32	29	42	36	32	29	35	32	29	34	31	29	34	31	29	28
8	40	33	29	26	39	32	28	26	32	28	25	31	28	25	30	27	25	24
9	36	29	25	22	36	29	25	22	29	25	22	28	25	22	27	24	22	21
10	34	27	23	20	33	26	22	20	26	22	20	25	22	20	25	22	20	19

NOTE: THE ZONAL CAVITY CALCULATION TECHNIQUE IS ACCURATE WHEN LUMINAIRES WITH SYMMETRIC CANDELA DISTRIBUTIONS ARE EMPLOYED AND WHEN THE LUMINAIRES ARE LOCATED SYMMETRICALLY THROUGHOUT THE ROOM. THIS UNIT HAS SPECIAL CHARACTERISTICS AND THEREFORE THESE COEFFICIENTS SHOULD BE USED WITH CAUTION.

THIS TEST WAS CONDUCTED USING RELATIVE PHOTOMETRY TECHNIQUES ACCORDING TO STANDARD IESNA PROCEDURES. THE USER MUST THEREFORE USE CAUTION IN THE FOLLOWING SITUATIONS: 1) THIS TEST WAS PERFORMED USING A SPECIFIC BALLAST/LAMP COMBINATION. EXTRAPOLATION OF THESE DATA FOR OTHER BALLAST/LAMP COMBINATIONS MAY PRODUCE ERRONEOUS RESULTS. 2) ACCORDING TO IESNA PROCEDURES, THE BALLAST(S) AND LAMP(S) ARE PRESUMED TO PRODUCE 100% OF RATED OUTPUT. AN APPROPRIATE BALLAST FACTOR MUST BE APPLIED TO THE LUMEN OUTPUT RATINGS AND LUMINOUS INTENSITY VALUES GIVEN. 3) THIS TEST WAS CONDUCTED IN A CONTROLLED LABORATORY ENVIRONMENT WHERE THE AMBIENT TEMPERATURE WAS HELD AT 25°C ±1°C. FIELD PERFORMANCE MAY DIFFER PARTICULARLY IN REGARDS TO CHANGE IN LUMINOUS OUTPUT AS A RESULT OF DIFFERENCE IN AMBIENT TEMPERATURE AND METHOD OF MOUNTING THE LUMINAIRE.



LUMINAIRE TESTING LABORATORY, INC.



SUSTAINING
MEMBER

905 Harrison Street · Allentown, PA 18103 · (610) 770-1044 · Fax (610) 770-8912 · www.LuminaireTesting.com

LTL NUMBER: 06202

DATE: 10-26-2001

PREPARED FOR: VANTAGE LUMINAIRES

VISUAL COMFORT PROBABILITY TABLE

RATED LUMENS PER LAMP 900.

100. FC. ROOM		REFLECTANCES 80/50/20 LUMINAIRES 0 DEG PLANE				LUMINAIRES 90 DEG PLANE			
W	L	8.5	10.0	13.0	16.0	8.5	10.0	13.0	16.0
20	20	64	53	49	39	61	51	45	32
20	30	64	53	49	47	61	52	45	41
20	40	64	53	49	48	61	52	45	41
20	60	64	53	49	48	62	52	46	41
30	20	64	53	53	40	61	52	50	35
30	30	64	53	54	46	61	52	50	41
30	40	64	53	54	46	62	52	50	41
30	60	64	53	54	46	62	52	50	41
30	80	64	53	54	46	62	52	50	41
40	20	64	53	53	46	61	52	50	41
40	30	64	53	54	50	62	52	50	45
40	40	64	53	54	50	62	52	50	45
40	60	65	53	54	51	62	52	50	46
40	80	65	53	54	51	62	52	51	46
40	100	65	53	54	51	62	52	51	46
60	30	64	53	54	50	62	52	50	45
60	40	64	53	54	50	62	52	50	45
60	60	65	53	54	51	62	52	50	46
60	80	65	54	54	51	62	52	51	46
60	100	65	54	54	51	62	52	51	46
100	40	65	53	54	51	62	52	50	46
100	60	65	53	54	51	62	52	51	46
100	80	65	54	54	51	62	52	51	46
100	100	65	54	54	51	62	52	51	46



LUMINAIRE TESTING LABORATORY, INC.



SUSTAINING
MEMBER

905 Harrison Street · Allentown, PA 18103 · (610) 770-1044 · Fax (610) 770-8912 · www.LuminaireTesting.com

LTL TEST #06202

CIRCLE-OF-LIGHT

Ft below	FC nadir	Dia @ 50%
6.0	11.9	8.9
8.0	6.7	11.9
10.0	4.3	14.9
12.0	3.0	17.8
14.0	2.2	20.8
16.0	1.7	23.8

NOTE: 'Dia' spans the edge-points that are half of nadir FC