



# LUMINAIRE TESTING LABORATORY, INC.



SUSTAINING  
MEMBER

905 Harrison Street · Allentown, PA 18103 · (610) 770-1044 · Fax (610) 770-8912 · [www.LuminaireTesting.com](http://www.LuminaireTesting.com)

LTL NUMBER: 06204

DATE: 10-27-2001

PREPARED FOR: VANTAGE LUMINAIRES

CATALOG NUMBER: 6HF2X26E1-6602SCL

LUMINAIRE: FORMED STEEL HOUSING, SPUN SEMI-SPECULAR ALUMINUM  
REFLECTOR, NO ENCLOSURE.

LAMPS: TWO SYLVANIA CF26DD/E/835 RATED AT 1800 LUMENS EACH.

BALLAST: ONE ADVANCE ICF-2S26-H1-LD

MOUNTING: RECESSED

TOTAL INPUT WATTS = 52.0 AT 120.0 VOLTS

THE 0 DEGREE PLANE IS PARALLEL WITH THE LAMPS.

## CANDELA DISTRIBUTION

	0.0	22.5	45.0	67.5	90.0	112.5	135.0	157.5	180.0	FLUX
0	845	845	845	845	845	845	845	845	845	
5	813	845	873	894	904	892	874	854	833	84
15	750	908	1014	1084	1110	1101	1041	937	784	282
25	742	852	1035	1038	1097	1069	1076	910	804	449
35	655	751	795	832	867	854	839	828	741	511
45	510	557	596	636	652	666	642	612	589	476
55	406	407	392	378	354	347	346	347	343	254
65	7	7	6	6	7	6	6	6	7	7
75	0	0	0	0	0	0	0	0	0	0
85	0	0	0	0	0	0	0	0	0	0
90	0	0	0	0	0	0	0	0	0	0

## ZONAL LUMEN SUMMARY

ZONE	LUMENS	%LAMP	%FIXT
0- 30	815	22.7	39.5
0- 40	1326	36.8	64.3
0- 60	2057	57.1	99.7
0- 90	2063	57.3	100.0
90-180	0	0.0	0.0
0-180	2063	57.3	100.0

TOTAL LUMINAIRE EFFICIENCY: 57.3%

CIE TYPE: DIRECT

PLANE: 0-DEG 90-DEG 180-DEG

SPACING CRITERIA: 1.2 1.5 1.4

LUMINOUS DIAMETER: 6.250

## LUMINANCE IN CANDELA PER SQUARE METER

ANGLE IN DEG	AVERAGE 0-DEG	AVERAGE 45-DEG	AVERAGE 90-DEG
0	42688.	42688.	42688.
45	36436.	42581.	46581.
55	35759.	34526.	31179.
65	837.	717.	837.
75	0.	0.	0.
85	0.	0.	0.

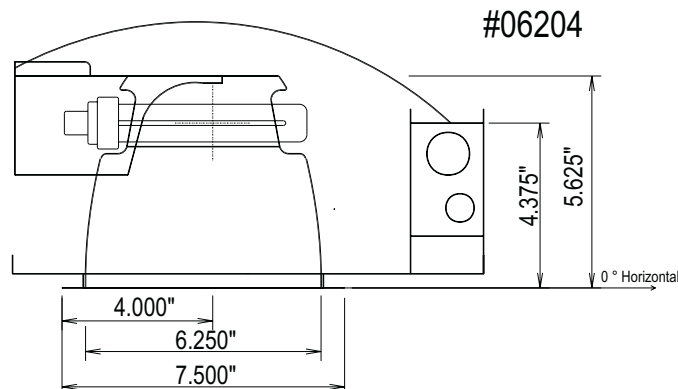

TESTED BY HERSCHEL SCHRECK  
CHECKED BY MIKE GRATHER

THIS REPORT BASED ON LM-41 AND OTHER PERTINENT IES PROCEDURES.

905 Harrison Street · Allentown, PA 18103 · (610) 770-1044 · Fax (610) 770-8912 · [www.LuminaireTesting.com](http://www.LuminaireTesting.com)

LTL NUMBER: 06204

DATE: 10-27-2001

PREPARED FOR: VANTAGE LUMINAIRES

## CANDELA DISTRIBUTION

[illegible]

## ZONAL LUMEN SUMMARY

AGE	NUMBER OF MEN	NUMBER OF WOMEN	NUMBER OF CHILDREN
0-5	5	20.	
5-10	10	64.	
10-15	15	114.	
15-20	20	168.	
20-25	25	211.	
25-30	30	238.	
30-35	35	252.	
35-40	40	259.	
40-45	45	255.	
45-50	50	221.	
50-55	55	192.	
55-60	60	62.	
60-65	65	4.	
65-70	70	2.	
70-75	75	0.	
75-80	80	0.	
80-85	85	0.	
85-90	90	0.	

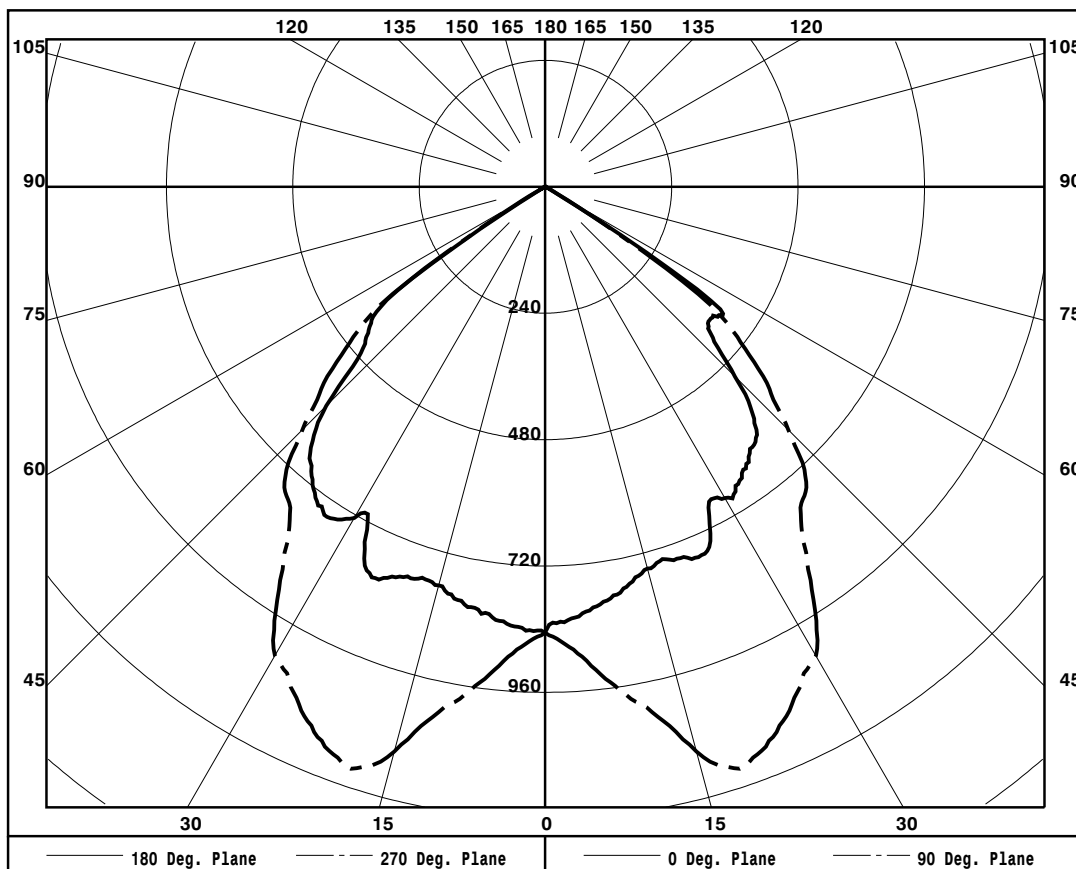



LUMINAIRE TESTING LABORATORY, INC.



SUSTAINING  
MEMBER

905 Harrison Street · Allentown, PA 18103 · (610) 770-1044 · Fax (610) 770-8912 · [www.LuminaireTesting.com](http://www.LuminaireTesting.com)

LTL NUMBER: 06204

DATE: 10-27-2001

PREPARED FOR: VANTAGE LUMINAIRES

COEFFICIENTS OF UTILIZATION - ZONAL CAVITY METHOD

EFFECTIVE FLOOR CAVITY REFLECTANCE 0.20

RC	80				70				50			30			10			0
RW	70	50	30	10	70	50	30	10	50	30	10	50	30	10	50	30	10	0
0	68	68	68	68	67	67	67	67	64	64	64	61	61	61	58	58	58	57
1	64	63	61	59	63	61	60	58	59	58	57	57	56	55	55	54	53	52
2	61	57	55	52	59	56	54	52	54	52	51	53	51	49	51	50	48	47
3	57	52	49	46	55	51	48	46	50	47	45	48	46	44	47	45	44	43
4	53	48	44	41	52	47	43	41	46	43	40	44	42	40	43	41	39	38
5	49	43	39	36	48	43	39	36	42	38	36	41	38	35	40	37	35	34
6	46	39	35	32	45	39	35	32	38	34	32	37	34	31	36	33	31	30
7	42	36	31	28	41	35	31	28	34	31	28	34	30	28	33	30	28	27
8	39	32	28	25	38	32	28	25	31	27	25	30	27	24	30	27	24	23
9	36	29	24	22	35	28	24	21	28	24	21	27	24	21	27	23	21	20
10	33	26	22	19	32	26	22	19	25	21	19	25	21	19	24	21	19	18

NOTE: THE ZONAL CAVITY CALCULATION TECHNIQUE IS ACCURATE WHEN LUMINAIRES WITH SYMMETRIC CANDELA DISTRIBUTIONS ARE EMPLOYED AND WHEN THE LUMINAIRES ARE LOCATED SYMMETRICALLY THROUGHOUT THE ROOM. THIS UNIT HAS SPECIAL CHARACTERISTICS AND THEREFORE THESE COEFFICIENTS SHOULD BE USED WITH CAUTION.

THIS TEST WAS CONDUCTED USING RELATIVE PHOTOMETRY TECHNIQUES ACCORDING TO STANDARD IESNA PROCEDURES. THE USER MUST THEREFORE USE CAUTION IN THE FOLLOWING SITUATIONS: 1) THIS TEST WAS PERFORMED USING A SPECIFIC BALLAST/LAMP COMBINATION. EXTRAPOLATION OF THESE DATA FOR OTHER BALLAST/LAMP COMBINATIONS MAY PRODUCE ERRONEOUS RESULTS. 2) ACCORDING TO IESNA PROCEDURES, THE BALLAST(S) AND LAMP(S) ARE PRESUMED TO PRODUCE 100% OF RATED OUTPUT. AN APPROPRIATE BALLAST FACTOR MUST BE APPLIED TO THE LUMEN OUTPUT RATINGS AND LUMINOUS INTENSITY VALUES GIVEN. 3) THIS TEST WAS CONDUCTED IN A CONTROLLED LABORATORY ENVIRONMENT WHERE THE AMBIENT TEMPERATURE WAS HELD AT 25°C ±1°C. FIELD PERFORMANCE MAY DIFFER PARTICULARLY IN REGARDS TO CHANGE IN LUMINOUS OUTPUT AS A RESULT OF DIFFERENCE IN AMBIENT TEMPERATURE AND METHOD OF MOUNTING THE LUMINAIRE.



LUMINAIRE TESTING LABORATORY, INC.



SUSTAINING  
MEMBER

905 Harrison Street · Allentown, PA 18103 · (610) 770-1044 · Fax (610) 770-8912 · [www.LuminaireTesting.com](http://www.LuminaireTesting.com)

LTL NUMBER: 06204

DATE: 10-27-2001

PREPARED FOR: VANTAGE LUMINAIRES

VISUAL COMFORT PROBABILITY TABLE

RATED LUMENS PER LAMP 1800.

100. FC. ROOM		REFLECTANCES 80/50/20 LUMINAIRES 0 DEG PLANE				LUMINAIRES 90 DEG PLANE			
W	L	8.5	10.0	13.0	16.0	8.5	10.0	13.0	16.0
20	20	56	34	24	19	52	35	23	16
20	30	56	34	32	26	52	35	31	22
20	40	56	35	32	32	52	35	31	28
20	60	56	35	32	32	52	35	31	28
30	20	56	38	32	20	52	38	31	17
30	30	56	38	40	27	52	38	39	24
30	40	56	38	40	33	52	38	39	30
30	60	56	38	40	33	52	38	39	30
30	80	56	38	40	33	52	38	40	30
40	20	56	38	35	25	52	38	34	22
40	30	56	38	43	32	52	38	42	29
40	40	56	38	43	37	52	38	42	34
40	60	56	38	43	37	52	38	42	34
40	80	56	38	43	37	52	38	42	34
40	100	56	38	43	37	52	38	42	34
60	30	56	38	43	35	52	38	42	32
60	40	56	38	43	39	52	38	42	36
60	60	56	38	43	40	52	38	42	36
60	80	56	38	43	40	52	38	42	36
60	100	57	38	43	40	52	38	42	36
100	40	56	38	43	40	52	38	42	36
100	60	57	38	43	40	52	38	42	36
100	80	57	38	43	40	52	38	42	36
100	100	57	38	43	40	52	38	42	37



LUMINAIRE TESTING LABORATORY, INC.



SUSTAINING  
MEMBER

905 Harrison Street · Allentown, PA 18103 · (610) 770-1044 · Fax (610) 770-8912 · [www.LuminaireTesting.com](http://www.LuminaireTesting.com)

LTL TEST #06204

CIRCLE-OF-LIGHT

Ft below	FC nadir	Dia @ 50%
6.0	23.5	8.6
8.0	13.2	11.5
10.0	8.4	14.4
12.0	5.9	17.2
14.0	4.3	20.1
16.0	3.3	23.0

NOTE: 'Dia' spans the edge-points that are half of nadir FC